

Exhaust Manifold

Replacement

NOTE: Use new gaskets and self-locking nuts when reassembling.

CAUTION:

- Check for folds or scratches on the surface of the gasket.
- Replace with a new gasket if damaged.

D16Y2 engine:

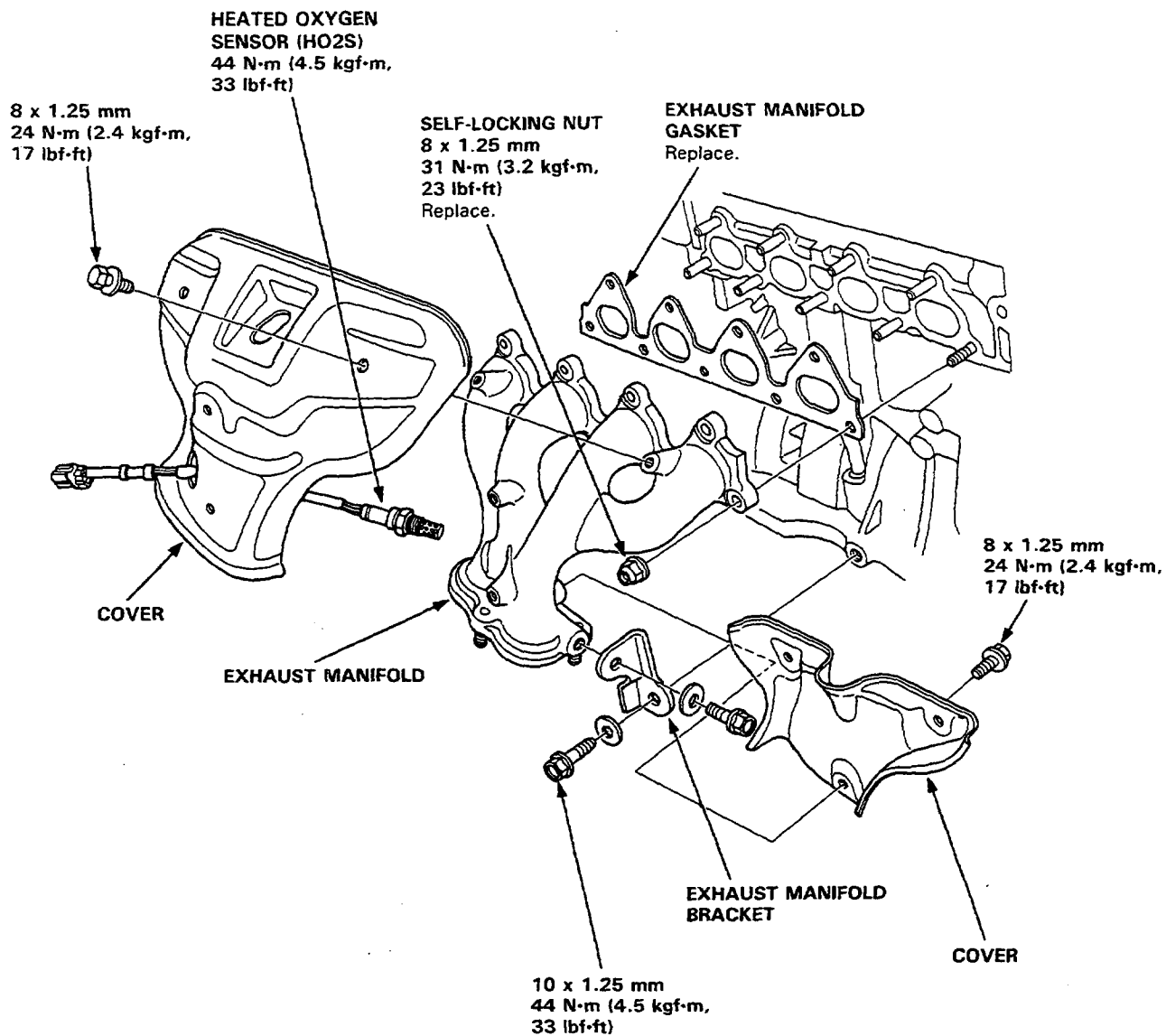



D15Z3 engine:

TWC Inspection:

Make a visual check for plugging, melting or cracking of the catalyst.

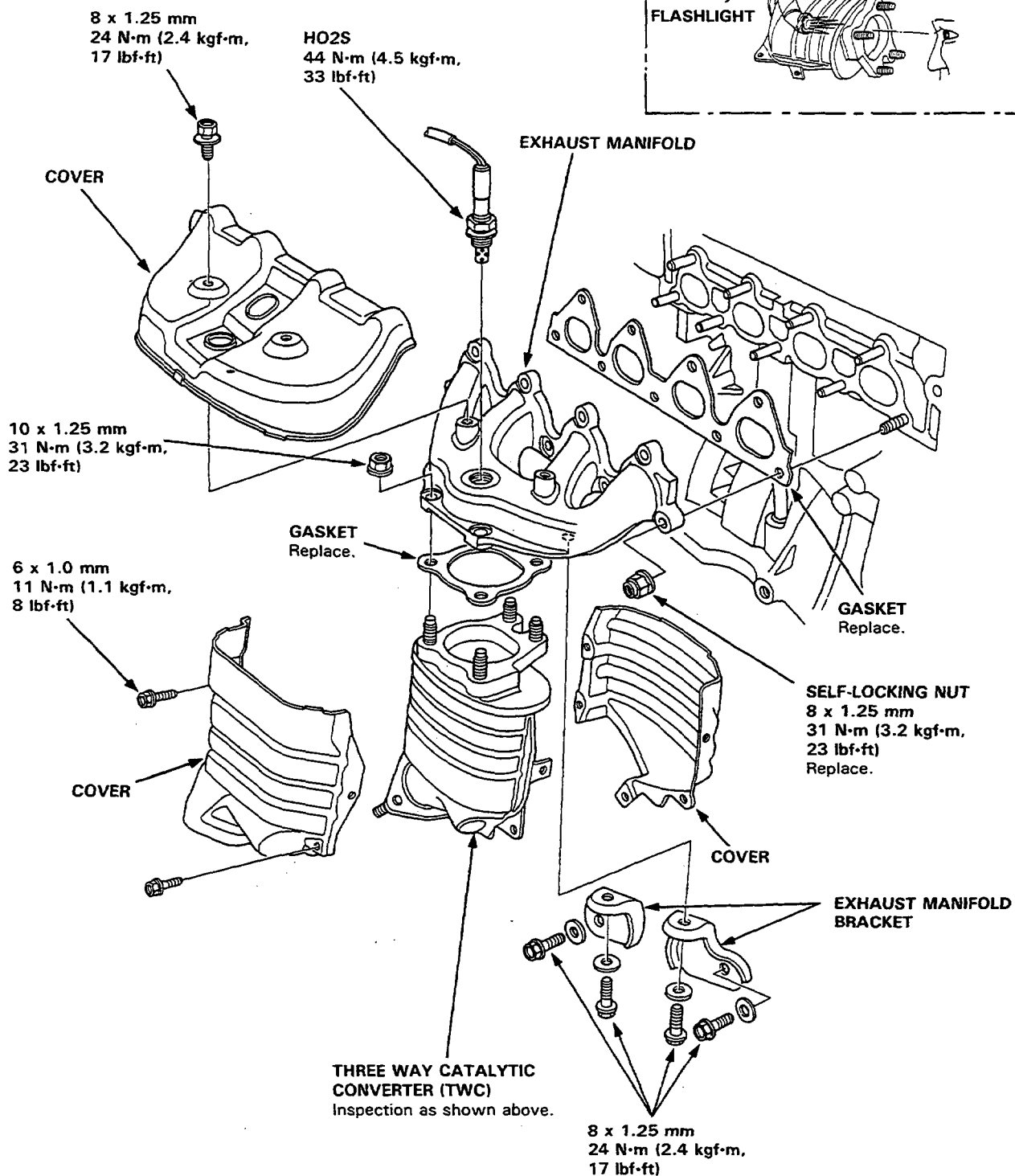
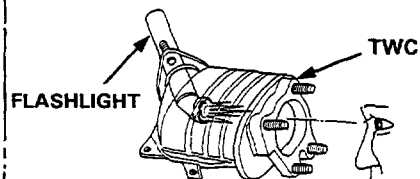

(cont'd)

Exhaust Manifold

Replacement (cont'd)

NOTE: Use new gaskets and self-locking nuts when reassembling.

CAUTION:

- Check for folds or scratches on the surface of the gasket.
- Replace with a new gasket if damaged.

D16Y3, D14A2 engines:

